

特征/Features

1. S3B, S3R, S3L, S3V series reversing the external force is provided by external agencies. Can be used for position detection or travel switch;
2. S3PF, S3PM, S3PP, S3PL, S3Y, S3HS, S3C, S3D series as a manual operation, a variety of structure shape control neck, convenient use under different conditions;
3. cut-off structure, good sealing, reversing flexible, without lubrication;
4. or more location to install, easy to install and use;
5. Manipulated, S3D, S3Y, S3R and S3L series control head for metal, life Fear and more reliable stability.

1. S3B, S3R, S3L, S3V series reversing the external force is provided by external agencies. Can be used for position detection or travel switch;
2. S3PF, S3PM, S3PP, S3PL, S3Y, S3HS, manipulated, S3D department As a manual operation, a variety of structure shape control neck, convenient use under different conditions;
3. cut-off structure, good sealing, reversing flexible, without lubrication;
4. or more location to install, easy to install and use;
5. Manipulated, S3D, S3Y, S3R and S3L series control head for metal, life Fear and more reliable stability.

规格/Specification

型号 Model	S3B	S3R	S3D	S3V	S3R	S3L	S3Y	S3PM	S3PP	S3PF	S3PL	S3HS
工作介质 Working Medium	空气(经40微米以上滤网过滤)/Air(40 Micron Filtered Air)											
动作方式/Acting Type	外部控制直动式/External direct lift control											
接管口径/Port Size ①	05:M5; 06:PT1/8; 08:PT1/4											
有效截面积/Effective Sectional Area	05:2.5 mm ² (Cv=0.14); 06:8.0mm ² (Cv=0.45); 08:12.0mm ² (Cv=0.67)											
位通数/Position and Way NO.	三口二位											
润滑/Lubricate ②	不需要/Not Necessary											
使用压力范围/Working Pressure Range	0-0.8MPa(0-114psi)											
保证耐压力/Ensured Pressure Resistance	1.5MPa(215psi)											
工作温度/Working Temperature	-20-70											
本体材质/Material of Body	铝合金/Aluminum alloy											

① 接管牙型有NPT, G牙可供选择; To take over the selection of tooth type with NPT, G;
② 如有加润滑油, 中途不可停止, 建议润滑油为ISO VG32或同级油。If there are any lubrication, not stop halfway, suggest lubricating oil for ISO VG32 or oil at the same level.

流量图/Flow diagram

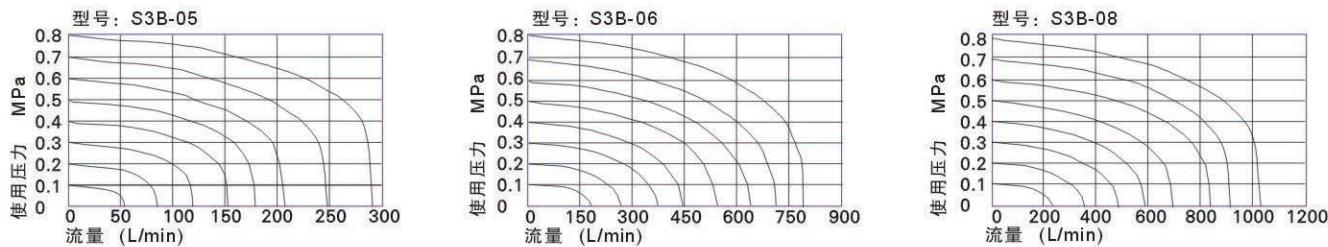

内部结构图/Internal structure

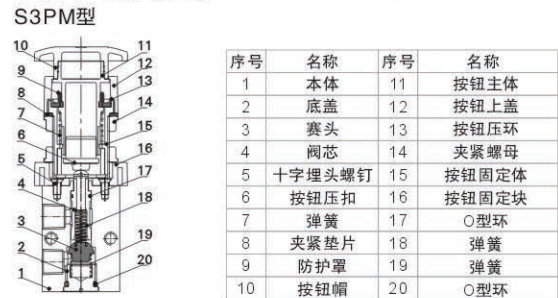

换向行程/

单位: mm

阀型号	阀芯行程	按钮行程
S3B	2.4-4.0	-
S3PF	2.4-4.0	3.8-5.4
S3PP	2.4-4.0	3.8-5.4
S3PM	2.4-4.0	3.8-5.4
S3PL	2.4-4.0	5.9-7.5
S3HS	2.4-4.0	5.1-6.7
阀型号	阀芯行程	滚轮(手柄)行程
S3R	2.4-3.4	5.5-7.8
S3L	2.4-3.4	6.0-8.6
S3V	2.4-3.8	3.4-4.8
S3C	2.4-3.8	14.4-18.4
S3D	2.4-3.8	7.4-9.4

安装与使用/Internal structure

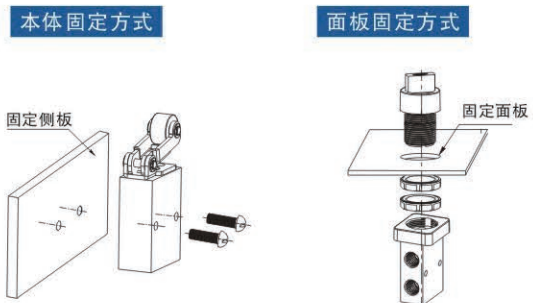

- 注意事项
- 1) 控制部分材料为工程塑料, 只允许人工用手操作。禁止用金属撞击来使阀切换。
 - 2) S3B, S3C, S3D, S3PM, S3PF, S3PP手动阀为手动复位。S3Y, S3HS, S3PL手动阀为手动复位。其中S3PL压入定位后, 须旋转按钮才能复位。
 - 3) 注意换向行程, 任何外力使阀换向时, 其换向行程都不能超过控制行程表规定的换向行程范围, 否则会造成阀体损坏。
 - 4) S3L单向滚轮阀只有单方向能使阀切换(由右向左撞击)。另一个方向无效撞击(由左向右)。
 - 5) 控制头组合可单独订购, 具体定稿方式参照右表。
- 1) the control part of the material is engineering plastics, only allow manual operated by hand. Use metallic to switch valve is prohibited.
- 2) S3B, manipulated, S3D, S3PM, S3PF, S3PP manual valve as a manual reset. S3Y, S3HS, S3PL manual Valve as a manual reset. After the S3PL YaRu positioning, must turn to rotate button to reset.
 - 3) pay attention to the reversing schedule, any external force make the reversing valve, control its reversing schedule cannot exceed schedule of reversing Cheng scope, otherwise it will cause the body is damaged.
 - 4) S3L roller one-way valve can make only a single direction valve switch (impact from right to left). In the other direction is invalid impact (from left to right).
 - 5) control head combination can separate order, finalized methods with reference to the right table.

外部规格/Internal structure

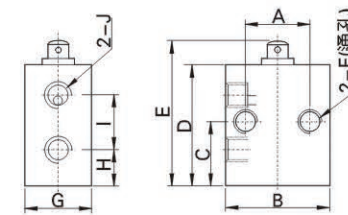

型号 / Model	A	B	C	D	E	F	G	H	I	J
M5	16	26	15	30	36	M5×0.8	16.5	9	13	M5×0.8
06	23	30	20.5	41	47	M5×0.8	16.5	11.5	17.5	PT1/8
08	24	34	22.5	46	52	M5×0.8	17.5	12	21	PT1/4

型号 Model	C 长柄型	D 短柄型	Y 摇柄型
订购方式	订购码 M3C210-P13A	规格 M3C210长柄组合	订购码 M3D210-P13A
适用产品	S3C05, S3C06, S3C08	S3D05, S3D06, S3D08	S3Y05, S3Y06, S3Y08
外部尺寸			

型号 Model	R 滚轮杆杆型	L 单向滚轮杆杆型	V 垂直滚轮型
订购方式	订购码 M3R210-P14A	规格 M3R210滚轮杆杆型组合	订购码 M3L210-P14A
适用产品	S3R05, S3R06, S3R08	S3L05, S3L06, S3L08	S3V05(06,08)-P14
外部尺寸			

型号 Model	PP 凸头按钮型	PM 蘑菇头按钮型	PL 停驻旋转按钮型
订购方式	订购码 S3PP05-P11A	规格 S3PP凸头按钮组合(绿色)	订购码 S3PM05-P11A
适用产品	S3PP05, S3PP06, S3PP08	S3PM05, S3PM06, S3PM08	S3PL05, S3PL06, S3PL08
外部尺寸			

型号 Model	PP 平头按钮型	外部尺寸	型号 Model	PP 旋钮型	外部尺寸
订购方式	订购码 S3PF05-P11A	规格 S3PF平头按钮组合(绿色)	订购方式	订购码 S3HS05-P11A	规格 S3HS旋钮组合(绿色)
适用产品	S3PF05, S3PF06, S3PF08		适用产品	S3HS05, S3HS06, S3HS08	